

Shut-off valve PN 250 / PN 400

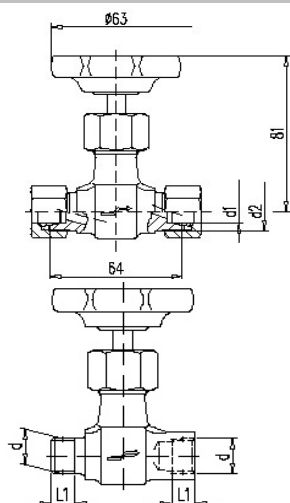

Execution 1

Shut-off valve PN 250 , tube fitting DIN 2353			
Tube O.D. d1	Material	Connection thread d2	Part-no.
12 mm	steel stainless steel	M 20 x 1,5	S 338.03.100 S 338.03.200

Execution 2

Shut-off valve PN 400 DN 6, male / female			
Connections		Part-no.	
d	L1 (mm)	Steel	Stainless steel
1/4 NPT	10	S 338.08.100	S 338.08.100

Execution 3

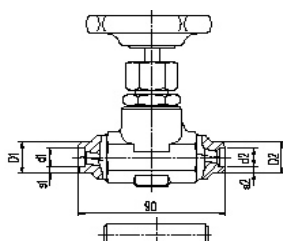

Shut-off valve PN 400 DN 8, weld connections							
Material	Connections						Part-no.
	D1	d1	S1	D2	d2	S2	
steel stainless steel	21,3	12,2	-	21,3	12,2	-	S 350.05.100 S 350.05.200
steel stainless steel	24	-	7,1	14	-	2,5	S 350.05.130.23 S 350.05.230.23

Execution 4 and execution 5

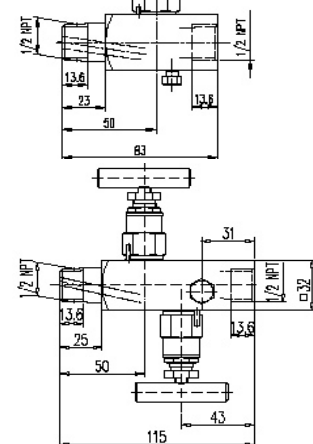

Shut-off valve / Double shut-off valve PN 420 DN 5 , male / female			
Material	Connections		Part-no.
	Inlet	Outlet	
steel stainless steel	male 1/2 NPT	female 1/2 NPT	N 354.16.101.05 N 354.16.401.05
execution with vent / test, connection female 1/4 NPT, with vent screw			N 354.60.101.05 N 354.60.401.05

Execution 1 to 3

Components	Steel	Stainless steel
	DIN - Material Number	
Body	1.0460	1.4571
Bonnet	1.0501	1.4571
Valve seat	1.4571	
Valve stem	1.4104	1.4571
Needle tip	1.4122	1.4571
Packing	PTFE up to 200°C special packing up to 300°C	
Union nut	steel	1.4571
Weld ends	1.5415	1.4571

Execution 4 and 5

Components	Steel	Stainless steel
	DIN - Material Number	
Body	1.0460	1.4404
Bonnet	1.0501	1.4571
Valve stem	1.4104	1.4571
Needle tip	1.4122	1.4571
Packing	PTFE up to 200°C special packing up to 400°C	
Gland nut	1.0501	1.4301
T-handle	stainless steel	

Other type of shut-off valves are deliverable