

## Multi-way cock PN 100 / DN 5

for direct mounting according DIN 19 213

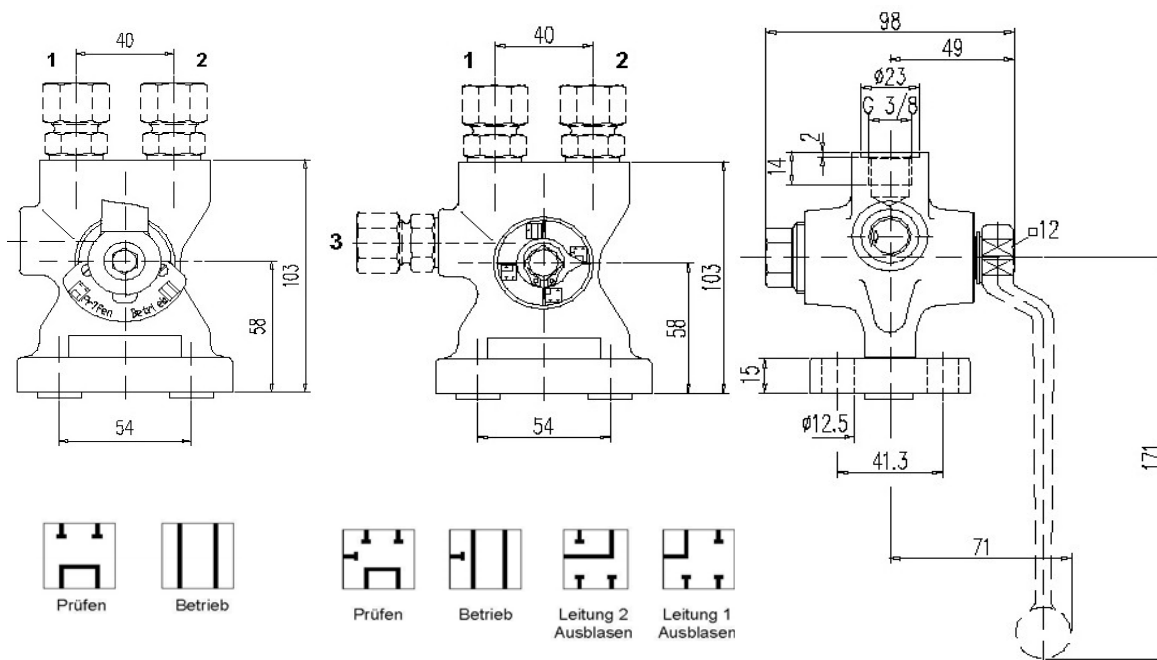

Material	Inlet 1 – 2	Blow off 3	Outlet	Part-no.
steel	G3/8 female thread according to DIN 3852		DIN 19 231 Form B1	S 345.06.100
stainless steel				S 345.06.200
steel	tube fitting O.D. 12 mm			S 345.06.101
stainless steel				S 345.06.201
steel	G3/8 female thread according to DIN 3852			S 345.06.114.11
stainless steel				S 345.06.214.11
steel	tube fitting O.D. 12 mm		S 345.06.115.11	
stainless steel			S 345.06.215.11	

Components	Steel	Stainless steel
	DIN - Material Number	
Body	1.0460	1.4571
Plug	1.4571	
Distance socket	stainless steel	
Indicating dial	1.4301	
Pressure screw	1.0501	1.4571
Insert ring	stainless steel	
Tube fitting and bulkhead male connection	steel	1.4571
Plug seal	PTFE - Compound	
Switch lever	black anodized aluminium	

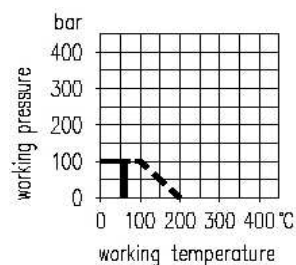

**Option**  
bulkhead male connection  
instead of tube fitting