

## Dirt Trap

### Application

Dirt traps get frequent used at steam-boilers for the level measuring and steam flow measurings with differential pressure transmitters. On request the dirt traps are installed into the impulse pipes to catch dirt such as rust or lime, and keep away dirt of transmitters through this.

### Connections

- 1 Impulse pipe
- 2 Transmitter
- 3 Weld connection
- 4 Outlet connection

The assembling, welding etc. is the responsibility of the operator. If necessary the Dirt traps are delivered on request with manufacturer certificate according to § 9 (2) 1 of the Pressurized Containers Ordinances as well as with material certificate according to DIN 50049 3.1A for the used materials and thus prepared for a later removal acceptance test by the TÜV.

Singles TÜV certificate of equalizing vessel with material certificate according to DIN 50049 3.1A is possible (costs according with effort)

Size	Form	Housing	Coupling
1	A	St 45.8 Mat.No.1.0405	St 45.8 Mat.No.1.0405
3	C	13CrMo44 Mat.No.1.7335	13CrMo44 Mat.No. 1.7335

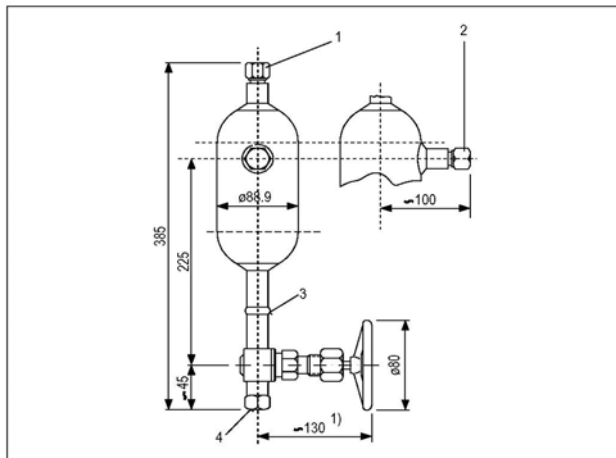
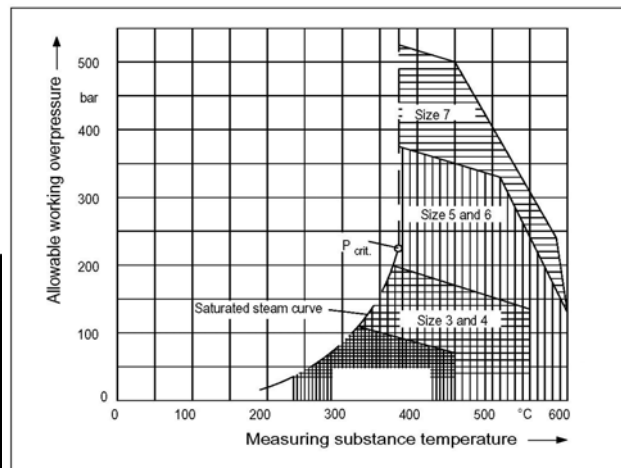

**Size 1 Form A**  
Ermeto ferrule-fitting for pipe Ø 12 mm

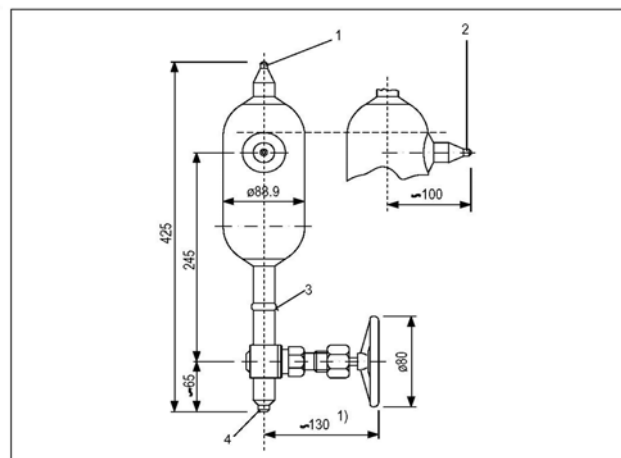

**Size 3 Form C**  
Weld connection for pipe Ø 14 mm X 2,5 mm  
1) opened

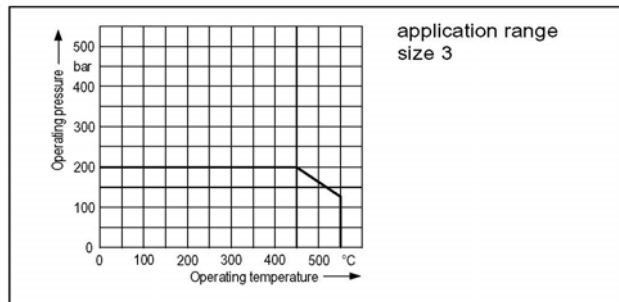
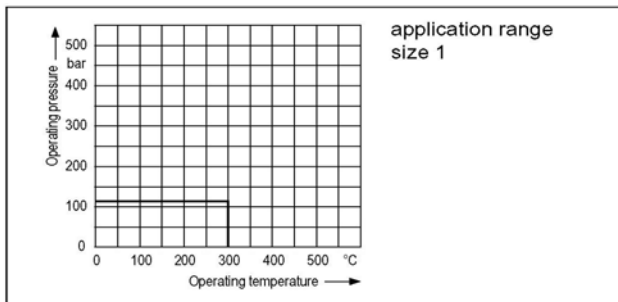

### Ordering Information

#### Dirt Trap

Size	Form	Volumen	Material	kg	Material Certificate	Stop Valve	Input / Output
1	A	~ 800 cm <sup>3</sup>	1.0405	~ 4,5	according to effort	DN 8 / PN 400	weld-/Ermeto connection
3	C	~ 700 cm <sup>3</sup>	1.7335	~ 5,2	according to effort	DN 8 / PN 400	weld-/Ermeto connection